

067-0609-00 CALIBRATION FIXTURE

Common Mode Rejection Checker

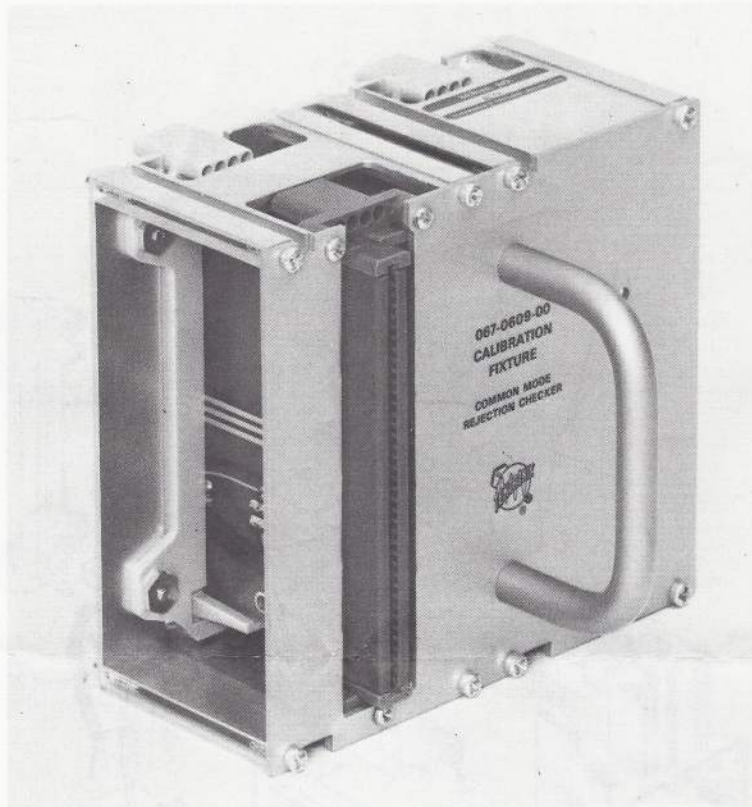

The 067-0609-00 Common Mode Rejection Checker is used in conjunction with the 067-0587-00 Signal Standardizer Fixture to determine the CMRR of 7000-Series Mainframe Vertical Interface Amplifiers. The 067-0609-00 CMR Checker plugs into both mainframe Vertical connectors at the same time. It accepts the 067-0587-00 Signal Standardizer through the left Vertical compartment of the mainframe. The 067-0609-00 routes the CW signal from the 067-0587-00 to both mainframe Vertical inputs, maintaining 50 Ω terminations to the Signal Standardizer. Precision-length coaxial cables introduce time delay to equalize arrival time of waveforms to each Vertical connector.

When a CW signal is applied to the CW (FREQ RESP) input of the 067-0587-00, an in-phase signal will be applied to the left Vertical amplifier and an opposite-phase signal to the right Vertical amplifier. With the mainframe VERTICAL MODE switch in ADD, the signals will cancel in the mainframe circuitry and the on-screen peak-to-peak display, referenced to the input signal amplitude (and frequency), indicates the common mode rejection performance of the mainframe.

FIGURE 1 EXPLODED

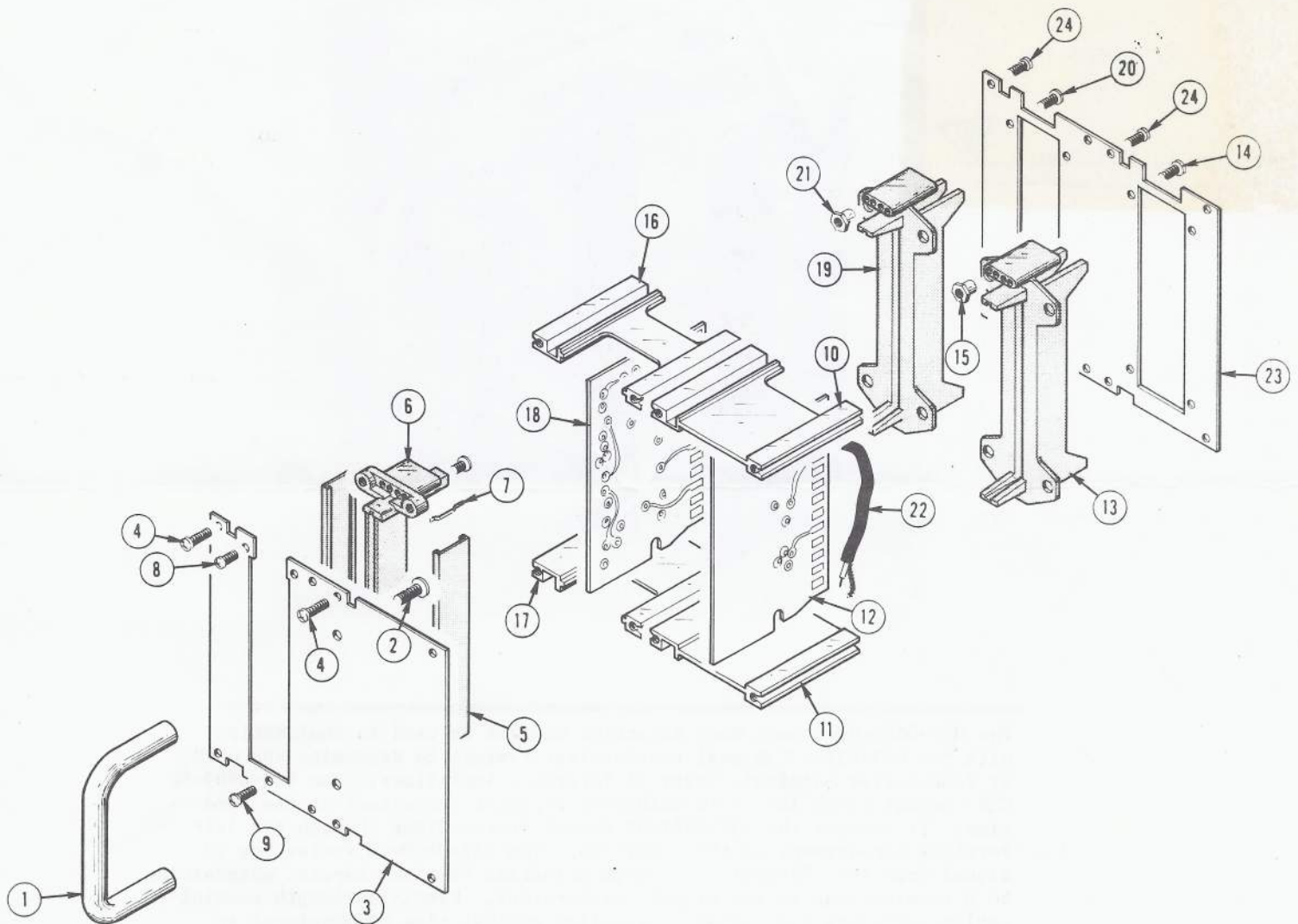

FIGURE 1 EXPLODED

Fig. & Index No.	Tektronix Part No.	Serial/Model No. Eff	No. Disc	Q t y	1 2 3 4 5	Description
1-1	367-0110-00			1		HANDLE, carrying
	- - - - -			-		mounting hardware: (not included w/handle)
-2	212-0507-00			2		SCREW, 6-32 x 0.375 inch, PHS
-3	E333-1290-00			1		PANEL, front
	- - - - -			-		mounting hardware: (not included w/panel)
-4	213-0192-00			8		SCREW, 6-32 x 0.250 inch, Fil HS
	E131-0767-01			1		CONNECTOR ASSEMBLY
	- - - - -			-		assembly includes:
-5	200-0950-00			2		COVER, plastic
-6	204-0365-00			1		BODY, plastic
-7	131-0726-04			1		CONTACT SET, 19 contacts
	- - - - -			-		mounting hardware: (not included w/assembly)
-8	211-0012-00			2		SCREW, 4-40 x 0.375 inch, PHS
-9	213-0088-00			1		SCREW, thread forming, #4 x 0.250, PHS
-10	E426-0614-00			1		FRAME SECTION, plug in, top right
-11	E426-0616-00			1		FRAME SECTION, plug in, bottom right
-12	E388-1534-00			1		BOARD, circuit
-13	E351-0217-00			1		GUIDE, circuit board
	- - - - -			-		mounting hardware: (not included w/guide)
-14	211-0510-00			4		SCREW, 6-32 x 0.375 inch, PHS
-15	E220-0557-00			4		NUT, sleeve, 0.118 inch long
-16	E426-0615-00			1		FRAME SECTION, plug in, top left
-17	E426-0617-00			1		FRAME SECTION, plug in, bottom left
-18	E388-1535-00			1		BOARD, circuit
-19	E351-0217-00			1		GUIDE, circuit board
	- - - - -			-		mounting hardware: (not included w/guide)
-20	211-0507-00			4		SCREW, 6-32 x 0.312 inch, PHS
-21	E220-0556-00			4		NUT, sleeve, 0.085 inch long
-22	175-0456-00			4		CABLE, RF, 100 Ω coaxial, 3.375 inches long
-23	E386-1650-00			1		PANEL, rear
	- - - - -			-		mounting hardware: (not included w/panel)
-24	213-0192-00			8		SCREW, 6-32 x 0.500 inch, Fil HS