

**201-2 SCOPE-MOBILE
DATE CODE 7331 AND ABOVE**



DATA SHEET

NO. 062-0715-01
DATE AUGUST, 1973



COPYRIGHT © 1973
TEKTRONIX INC.
ALL RIGHTS RESERVED

FIG. 1 201-2 SCOPE-MOBILE

Fig. & Index No.	Tektronix Part No.	Serial/Model No.		Q t y	1	2	3	4	5	Description
		Eff	Disc							
1-	- - - - -			-						201-2 SCOPE-MOBILE
-1	386-2693-00			2						scope-mobile includes: PLATE, trunnion support
-2	212-0518-00			1						mounting hardware for each: (not included w/plate) SCREW, 10-32 x 0.312 inch PHS
-3	200-1577-00			2						COVER, trunnion, plastic mounting hardware for each: (not included w/mount)
-4	214-0174-02			1						BOLT, square-neck
-5	210-1099-00			1						WASHER, plastic, 0.437 ID x 1.125 inch OD
-6	210-0922-00			1						WASHER, plastic, 0.750 ID x 1.125 inch OD
-7	210-0540-00			1						NUT, hex., 0.312-18 x 0.500 inch
-8	213-0341-00			8						SCREW, cap, 0.250-20 x 0.75 inch
	210-0076-00			8						WASHER, lock, 1.255 ID x 0.425 inch OD
-9	367-0026-02			1						HANDLE, tray mounting hardware: (not included w/handle)
-10	213-0135-00			4						SCREW, sheet metal #8 x 0.500 inch, 100° csk, FHS
-11	334-1005-04			1						TAG, 201-2
-12	436-0027-04			1						TRAY
-13	348-0187-00			2						FOOT, plastic mounting hardware for each: (not included w/foot)
-14	211-0565-00			1						SCREW, 6-32 x 0.250 inch, THS
-15	381-0190-00			2						BAR, tray stop mounting hardware for each: (not included w/bar)
-16	212-0039-00			2						SCREW, 8-32 x 0.375 inch THS
	367-0121-00			1						HANDLE ASSEMBLY handle assembly includes:
-17	367-0024-01			1						HANDLE, latch mounting hardware: (not included w/handle)
-18	214-1296-00			1						PIN, roll
-19	381-0185-02			1						BAR, latch
-20	387-0397-00			2						PLATE, bell crank
-21	129-0061-00			1						POST, pivot
-22	214-0179-00			2						LATCH, sliding
-23	214-0185-00			1						SPRING, latch
-24	354-0115-00			3						RING, retaining
-25	436-0039-00			1						ASSEMBLY, shelf assembly includes:
-26	107-0019-00			1						SHEET, linoleum
-27	426-0181-03			2						FRAME, leg, left rear, right front
-28	426-0182-03			2						FRAME, leg, right rear, left front
-29	401-0016-00			2						CASTER
-30	401-0023-00			2						CASTER, locking
-31	406-0923-00			4						BRACKET, corner
-32	213-0052-00			4						SCREW, sems, 0.250-20 x 1 inch, HHS

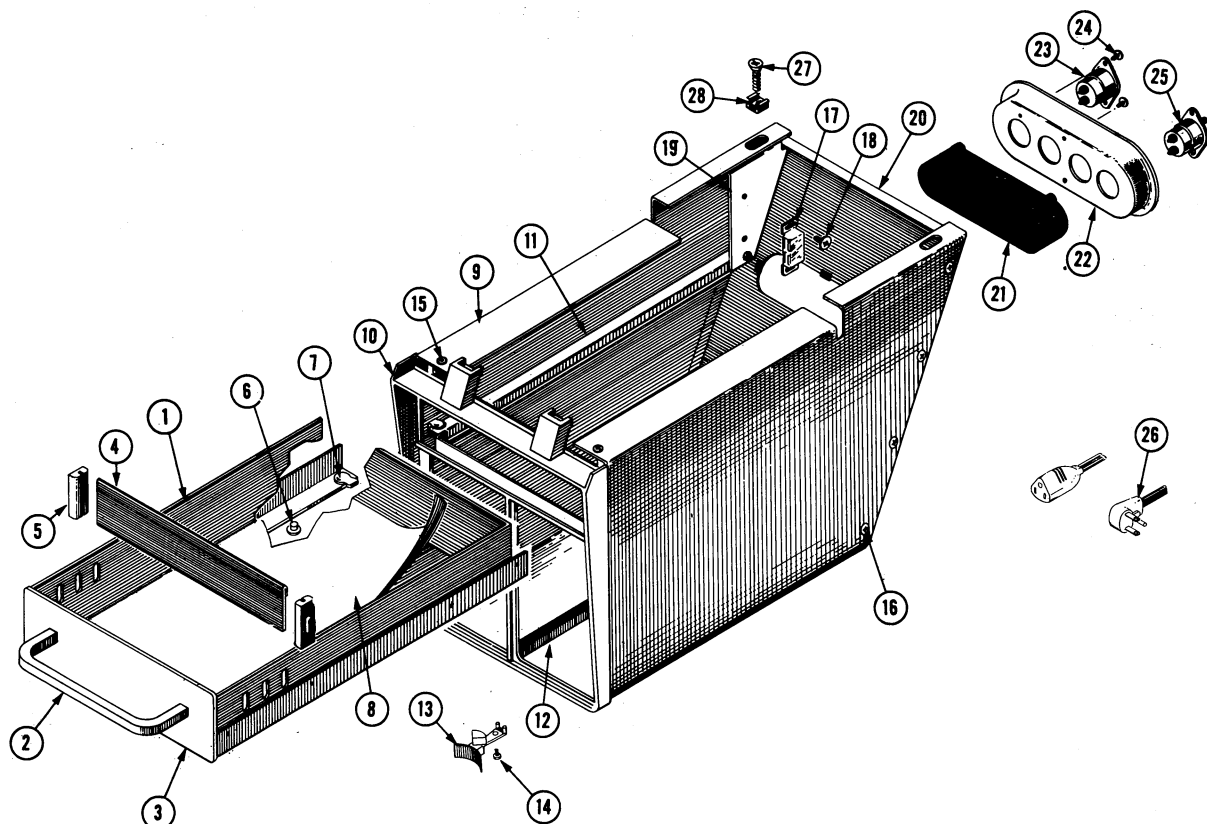

Fig. & Index No.	Tektronix Part No.	Serial/Model No. Eff Disc	Q t y	Description				
				1	2	3	4	5
				201-2 SCOPE-MOBILE				
2-	014-0013-00			ASSEMBLY, drawer & plug-in housing				
-	- - - - -		-	assembly includes:				
-1	436-0037-00		1	TRAY drawer				
-2	367-0036-02		1	HANDLE, drawer				
-	- - - - -		-	mounting hardware: (not included w/handle)				
	212-0039-00		2	SCREW, 8-32 x 3/8 inch, THS				
-3	333-0752-01		1	PANEL, front drawer				
-4	387-0781-00		1	PLATE, drawer divider				
-5	352-0060-00		2	HOLDER, drawer divider				
-6	401-0024-00		2	BEARING, drawer slide				
-7	401-0015-00		4	BEARING, drawer guide				
-8	107-0021-00		1	SHEET, felt				
-9	380-0051-00		1	HOUSING, drawer & plug-in				
-10	426-0180-00		1	FRAME, housing				
-11	351-0062-00		1 pr	GUIDE, drawer				
-	- - - - -		-	mounting hardware for each: (not included w/guide)				
	212-0039-00		1	SCREW, 8-32 x 3/8 inch, THS				
	213-0144-00		1	SCREW, sheet metal, #8 x 1/2 inch, THS				

FIG. 2 ACCESSORY STORAGE HOUSING (cont)

Fig. & Index No.	Tektronix Part No.	Serial/Model No. Eff Disc	Q † y 1 2 3 4 5					Description
2-12	351-0038-00		1					GUIDE, plug-in
	- - - - -		-					mounting hardware: (not included w/guide)
	211-0565-00		1					SCREW, 6-32 x 1/4 inch, THS
	211-0510-00		1					SCREW, 6-32 x 3/8 inch, PHS
-13	214-0638-00		1					ASSEMBLY, latch
	- - - - -		-					mounting hardware: (not included w/assembly)
-14	211-0513-00		1					SCREW, 6-32 x 5/8 inch, PHS
-15	211-0565-00		2					SCREW, 6-32 x 1/4 inch, THS
-16	213-0144-00		11					SCREW, sheet metal, #8 x 1/2 inch, THS
-17	214-0146-00		2					FASTENER, magnetic catch
	- - - - -		-					mounting hardware for each: (not included w/fastener)
-18	213-0124-00		2					SCREW, sheet metal, #6 x 1/4 inch, PHS
-19	406-0913-00		1					BRACKET, drawer guide, left
	406-0912-00		1					BRACKET, drawer guide, right
-20	387-0782-00		1					PLATE, housing back
	136-0102-00		1					ASSEMBLY, socket
	- - - - -		-					assembly includes:
-21	337-0402-00		1					SHIELD, black plastic
-22	406-0646-00		1					BRACKET, socket receptacle
-23	131-0669-00		3					SOCKET, 3 wire
	- - - - -		-					each socket includes:
	213-0146-00		1					Screw, thread forming, #6 x 0.313 inch, PHS
	211-0164-00		1					SCREW, sems, 6-32 x 1/4 inch, PHS
	205-0014-00		1					SHELL, mounting
	214-1016-01		1					INSULATOR, connector
	214-0145-00		2					SPRING, contact
	220-0444-00		1					NUT, square, 6-32 x 1/4 inch
	131-0670-01		1					SPRING, ground, connector
	204-0361-00		1					BODY, connector
	- - - - -		-					mounting hardware for each: (not included w/socket)
-24	213-0104-00		2					SCREW, thread forming, #6 x 3/8 inch, PHS
-25	131-0572-00		1					CONNECTOR, power, 3 contact, male
	- - - - -		-					connector includes:
	211-0614-00		1					SCREW, sems, 6-32 x 1/4 inch, PHS
	213-0146-00		1					SCREW, thread forming, #6 x 0.313 inch, PHS
	205-0014-00		1					SHELL, mounting
	214-1016-01		1					INSULATOR, connector
	214-0078-00		2					PIN, connecting
	204-0335-00		1					BODY-CONTACT ASSEMBLY
	- - - - -		-					mounting hardware: (not included w/connector)
	213-0104-00		2					SCREW, thread forming, #6 x 3/8 inch, PHS
	- - - - -		-					mounting hardware: (not included w/assembly)
	213-0144-00		4					SCREW, sheet metal, #8 x 1/2 inch, THS
-26	161-0030-01		1					CORD, power, 3 conductor, 9 feet long
	- - - - -		-					mounting hardware: (not included w/assembly)
-27	212-0043-00		4					SCREW, 8-32 x 1/2 inch, 100° csk PHS
-28	210-0594-00		4					NUT, retainer

FIG. 2 ACCESSORY STORAGE HOUSING

Fig. & Index No.	Tektronix Part No.	Serial/Model No.		Q t y						Description
		Eff	Disc		1	2	3	4	5	
203 SCOPE-MOBILE										
2-	014-0007-00	Md1 A	Md1 A	-						ASSEMBLY, plug-in housing
	- - - - -			-						assembly includes:
-1	380-0029-00			1						HOUSING, plug-in
-2	387-0473-00			1						PLATE, housing back
-3	426-0143-00			1						FRAME, housing
-4	351-0038-00			1						GUIDE, plug-in
	- - - - -			-						mounting hardware: (not included w/guide)
	211-0537-00			2						SCREW, 6-32 x 3/8 inch, THS
-5	213-0008-00			13						SCREW, sheet metal, #8 x 3/8 inch, THS
-6	211-0537-00			2						SCREW, 6-32 x 3/8 inch, THS
	136-0102-00			1						ASSEMBLY, socket
	- - - - -			-						assembly includes:
-7	337-0402-00			1						SHIELD, black plastic
-8	406-0646-00			1						BRACKET, socket receptacle
-9	136-0054-00			3						SOCKET, 3 wire
	- - - - -			-						mounting hardware for each:
	- - - - -			-						(not included w/socket)
-10	213-0041-00			2						SCREW, thread cutting, 6-32 x 3/8 inch, PHS
-11	131-0150-00			1						CONNECTOR, 3 wire, male
	- - - - -			-						mounting hardware: (not included w/connector)
	213-0041-00			1						SCREW, thread cutting, 6-32 x 3/8 inch, PHS
	- - - - -			-						mounting hardware: (not included w/assembly)
	213-0008-00			4						SCREW, sheet metal, #8 x 3/8 inch, THS
-12	161-0014-00			1						CORD, power, 3 wire, 20 inches
-13	381-0192-00			2						BAR, plug-in securing
	- - - - -			-						mounting hardware for each: (not included w/bar)
	212-0004-00			2						SCREW, 8-32 x 5/16 inch
	- - - - -			-						mounting hardware: (not included w/assembly)
-14	212-0070-00			2						SCREW, 8-32 x 5/16 inch, FHS
-15	212-0043-00			2						SCREW, 8-32 x 1/2 inch, FHS
	210-0557-00			2						NUT, square, 8-32 x 11/32 inch
201-2 SCOPE-MOBILE										
	014-0013-00	Md1 B								ASSEMBLY, drawer & plug-in housing
	- - - - -			-						assembly includes:
-16	436-0037-00			1						TRAY drawer
-17	367-0036-00		7213	1						HANDLE drawer
	367-0036-02	7214		1						HANDLE, drawer
	- - - - -			-						mounting hardware: (not included w/handle)
	212-0039-00			2						SCREW, 8-32 x 3/8 inch, THS
-18	333-0752-00		7213	1						PANEL, front drawer
	333-0752-01	7214		1						PANEL, front drawer
-19	387-0781-00			1						PLATE, drawer divider
-20	352-0060-00			2						HOLDER, drawer divider
-21	401-0024-00			2						BEARING, drawer slide
-22	401-0015-00			4						BEARING, drawer guide
-23	107-0021-00			1						SHEET, felt
-24	380-0051-00			1						HOUSING, drawer & plug-in
-25	426-0180-00			1						FRAME, housing
-26	351-0062-00			1 pr						GUIDE, drawer
	- - - - -			-						mounting hardware for each: (not included w/guide)
	212-0039-00			1						SCREW, 8-32 x 3/8 inch, THS
	213-0144-00			1						SCREW, sheet metal, #8 x 1/2 inch, THS

FIG. 2 ACCESSORY STORAGE HOUSING (cont)

Fig. & Index No.	Tektronix Part No.	Serial/Model No.		Q					Description
		Eff	Disc	t	y	1	2	3	
2-27	351-0038-00	Md1 B	Md1 D	1					GUIDE, plug-in
	- - - - -			-					mounting hardware: (not included w/guide)
	211-0565-00			1					SCREW, 6-32 x 1/4 inch, THS
	211-0510-00			1					SCREW, 6-32 x 3/8 inch, PHS
-28	214-0638-00	Md1 D		1					ASSEMBLY, latch
	- - - - -			-					mounting hardware: (not included w/assembly)
-29	211-0513-00			1					SCREW, 6-32 x 5/8 inch, PHS
-30	211-0565-00			2					SCREW, 6-32 x 1/4 inch, THS
-31	213-0144-00			11					SCREW, sheet metal, #8 x 1/2 inch, THS
-32	214-0146-00			2					FASTENER, magnetic catch
	- - - - -			-					mounting hardware for each: (not included w/fastener)
-33	213-0124-00			2					SCREW, sheet metal, #6 x 1/4 inch, PHS
-34	406-0913-00			1					BRACKET, drawer guide, left
	406-0912-00			1					BRACKET, drawer guide, right
-35	387-0782-00			1					PLATE, housing back
	136-0102-00			1					ASSEMBLY, socket
	- - - - -			-					assembly includes:
-36	337-0402-00			1					SHIELD, black plastic
-37	406-0646-00			1					BRACKET, socket receptacle
-38	131-0669-00			3					SOCKET, 3 wire
	- - - - -			-					each socket includes:
	213-0146-00			1					SCREW, thread forming, #6 x 0.313 inch, PHS
	211-0164-00			1					SCREW, sems, 6-32 x 1/4 inch, PHS
	205-0014-00			1					SHELL, mounting
	214-1016-01			1					INSULATOR, connector
	214-0145-00			2					SPRING, contact
	220-0444-00			1					NUT, square, 6-32 x 1/4 inch
	131-0670-01			1					SPRING, ground, connector
	204-0361-00			1					BODY, connector
	- - - - -			-					mounting hardware for each: (not included w/socket)
-39	213-0104-00			2					SCREW, thread forming, #6 x 3/8 inch, PHS
-40	131-0572-00			1					CONNECTOR, power, 3 contact, male
	- - - - -			-					connector includes:
	211-0614-00			1					SCREW, sems, 6-32 x 1/4 inch, PHS
	213-0146-00			1					SCREW, thread forming, #6 x 0.313 inch, PHS
	205-0014-00			1					SHELL, mounting
	214-1016-01			1					INSULATOR, connector
	214-0078-00			2					PIN, connecting
	204-0335-00			1					BODY-CONTACT ASSEMBLY
	- - - - -			-					mounting hardware: (not included w/connector)
	213-0104-00			2					SCREW, thread forming, #6 x 3/8 inch, PHS
	- - - - -			-					mounting hardware: (not included w/assembly)
	213-0144-00			4					SCREW, sheet metal, #8 x 1/2 inch, THS
-41	161-0030-01			1					CORD, power, 3 conductor, 9 feet long
	- - - - -			-					mounting hardware: (not included w/assembly)
-42	212-0043-00			4					SCREW, 8-32 x 1/2 inch, 100° csk, FHS
-43	210-0594-00			4					NUT, retainer