

131 POWER SUPPLY (117 VOLT) (Part No. 015-027)

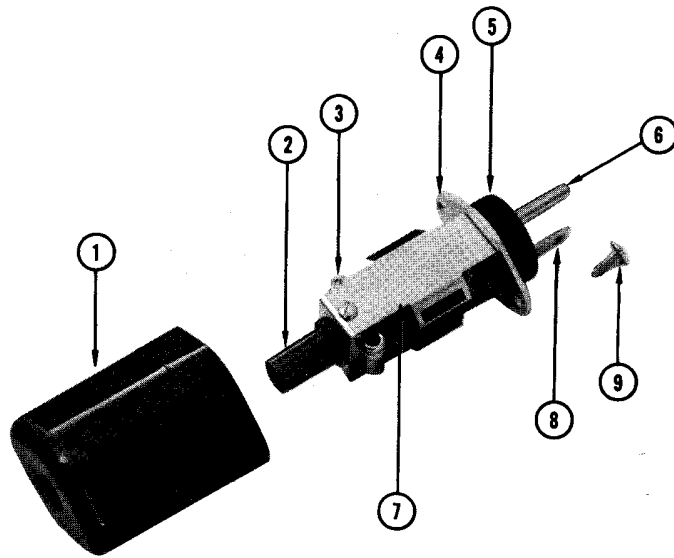
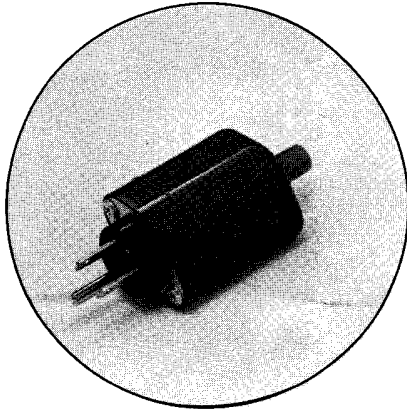

REF. NO.	PART NO.	SERIAL/MODEL NO.		QTY.	DESCRIPTION
		EFF.	DISC.		
1	200-484			1	COVER, transformer
2	131-190			1	CONNECTOR, molded
3	210-201			1	LUG, solder
	211-007			1	Mounting Hardware: (not included) SCREW, 4-40 x 3/16 inch BHS
	210-406			1	NUT, hex, 4-40 x 3/16 inch
4	387-265			1	PLATE, cover
5	200-185			1	COVER, 3 wire motor base
	211-015			1	SCREW, 4-40 x 1/2 inch RHS
	377-041			1	INSERT
6	129-060			1	POST, ground
7	406-732			1	BRACKET, transformer mounting Mounting Hardware: (not included) NUT, keps, 4-40 x 1/4 inch
8	210-586			2	
	214-078			2	PIN, connecting
9	213-041			2	SCREW, thread cutting, 6-32 x 3/8 inch Truss HS

FOR REPLACEMENT OF
ELECTRICAL COMPONENTS
SEE REVERSE SIDE

PUBLICATION NO.

061-932
(Revised)
January 1965



Copyright © 1963,
1965, Tektronix, Inc.
All Rights Reserved.

ELECTRICAL COMPONENTS

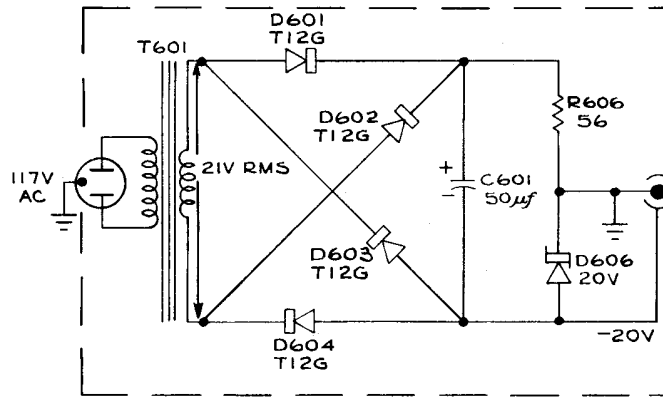

REF. NO.	PART NO.	SERIAL/MODEL NO.		QTY.	DESCRIPTION
		EFF.	DISC.		
	120-231			1	T601 TRANSFORMER, power
	152-008			4	D601, D602, D603, D604 DIODE, germanium, T12G
	290-158			1	C601 CAPACITOR, 50 μ f, EMT, 25 v
	316-560			1	R606 RESISTOR, 56 Ω , 1/4 w, 10%
	152-060			1	D606 DIODE, Zener, 20 v, 1 w, 10%