

CALIBRATION FIXTURE: FLEXIBLE EXTENDER

Part No. 067-1261-00

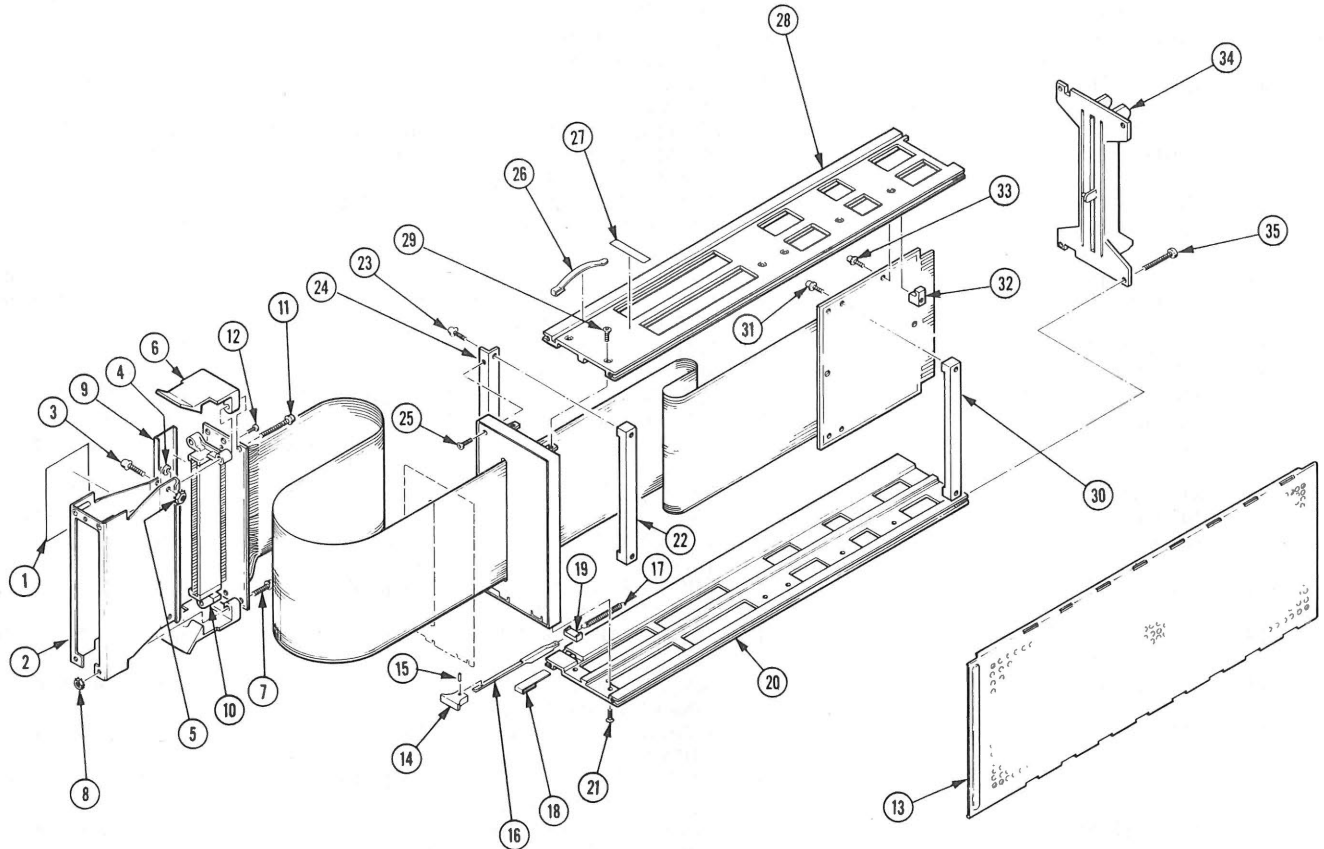

PRODUCT DESCRIPTION and COMPATIBILITY

The Flexible Extender is intended to facilitate calibration and troubleshooting of 11A and 11T-series plug-in units by allowing them to be operated while extended out of the oscilloscope mainframe.

The Flexible Extender is not compatible with 7000-series oscilloscopes. It is intended for use with 11000-series mainframes and plug-in units only.

Do not use the Flexible Extender with 7000-series mainframes, or with any 7000-series plug-in units which are not compatible with 11000-series mainframes.

When extended on the Flexible Extender, all plug-in unit functions will be operational. DC calibration is guaranteed if the Enhanced Accuracy feature is exercised while the plug-in unit is installed on the 067-1261-00 Flexible Extender. Degradation of bandwidth and transient response (i.e., rise time and aberration) of Display, Trigger, and Auxiliary Trigger outputs and inputs will be evident.

TYPICAL CONFIGURATIONS

One plug-in unit per Flexible Extender per Left, Center, or Right plug-in compartment per oscilloscope mainframe.

NO. 062-8894-00
DATE JUNE 1986

COPYRIGHT © 1986
TEKTRONIX INC.
ALL RIGHTS RESERVED

* M64606

Fig. & Index No.	Tektronix Part No.	Serial/Assembly No.		Qty	12345 Name & Description	Mfr. Code	Mfr. Part No.	
		Effective	Dscont					
1-1	334-6647-00			1	LABEL:1.315 X 2.125	80009	334-6647-00	
-2	200-3282-00			1	COVER,CONN: (ATTACHING PARTS)	80009	200-3282-00	
-3	211-0394-00			2	SCREW,MACHINE:4-40 X 0.875,PNH,STL CD PL	80009	211-0394-00	
-4	361-0020-00			2	INSULATOR,MSHR:0.156 ID X 0.3 OD X 0.78	80009	361-0020-00	
-5	210-0586-00			2	NUT,PL,ASSEM MA:4-40 X 0.25,STL CD PL (END ATTACHING PARTS)	78189	211-041800-00	
-6	105-0991-00			2	LATCH,EXTENDER:BLUE POLYCARBONATES (ATTACHING PARTS)	80009	105-0991-00	
-7	211-0302-00			2	SCR,ASSEM MSHR:4-40 X 0.75,PNH,STL,TORX DR	01536	ORDER BY DESCR	
-8	210-0586-00			2	NUT,PL,ASSEM MA:4-40 X 0.25,STL CD PL (END ATTACHING PARTS)	78189	211-041800-00	
-9	200-3155-00			2	COVER,CONN:0.768 L,BLUE POLYCARBONATE	80009	200-3155-00	
*-10	131-3544-00			1	CONN,RCPT,ELEC:HEADER,2 X 38 (ATTACHING PARTS)	80009	131-3544-00	
-11	211-0304-00			3	SCR,ASSEM MSHR:4-40X0.312,PNH,STL,T9 TORX	01536	ORDER BY DESCR	
-12	213-0984-00			2	SCREW,TPG,TR:2-28 X 0.312,PNH,STL (END ATTACHING PARTS)	80009	213-0984-00	
-13	337-1064-12			2	SHIELD,ELEC:SIDE FOR PLUG-IN UNIT	80009	337-1064-12	
-14	366-1058-00			1	KNOB:GRAY,0.625 X 0.255 X 0.485	80009	366-1058-00	
-15	214-1095-00			1	PIN,SPRING:0.187 L X 0.094 OD,STL,CD PL	22599	52-022-094-0187	
-16	105-0076-04			1	RELEASE BAR,LCH:PLUG-IN UNIT	80009	105-0076-04	
-17	214-1280-00			1	SPRING,HLCPS:0.14 OD X 1.126 L,TWIST LOOP, MUSIC WIRE	80009	214-1280-00	
-18	214-1054-00			1	SPRING,FLAT:0.825 X 0.322,SST	80009	214-1054-00	
-19	105-0075-00			1	BOLT,LATCH:	80009	105-0075-00	
-20	426-2061-00			1	FR SECT,PLUG-IN:LOWER,ALUMINUM (ATTACHING PARTS)	80009	426-2061-00	
-21	211-0392-00			2	SCREW,MACHINE:4-40 X 0.25,FLH,82 DEG,STL (END ATTACHING PARTS)	80009	211-0392-00	
-22	343-1276-00			1	CLAMP,CABLE:4.15 X 0.375,ALUMINUM (ATTACHING PARTS)	80009	343-1276-00	
-23	211-0304-00			2	SCR,ASSEM MSHR:4-40X0.312,PNH,STL,T9 TORX (END ATTACHING PARTS)	01536	ORDER BY DESCR	
-24	386-5402-00			1	SUPPORT,CABLE:4.2 X 0.5,ALUMINUM (ATTACHING PARTS)	80009	386-5402-00	
-25	211-0392-00			3	SCREW,MACHINE:4-40 X 0.25,FLH,82 DEG,STL (END ATTACHING PARTS)	80009	211-0392-00	
-26	214-1061-00			1	CONTACT,ELEC:GROUNDING,CU BE	80009	214-1061-00	
-27	334-3438-00			1	MARKER,IDENT:MARKED TURN OFF POWER	80009	334-3438-00	
-28	253-0176-00			8	TAPE,PRESS SENS:VINYL FOAM,0.5 X 0.062,	85471	ORDER BY DESCR	
-28	426-2060-00			1	FR SECT,PLUG-IN:UPPER,ALUMINUM (ATTACHING PARTS)	80009	426-2060-00	
-29	211-0392-00			2	SCREW,MACHINE:4-40 X 0.25,FLH,82 DEG,STL (END ATTACHING PARTS)	80009	211-0392-00	
-30	343-1276-00			1	CLAMP,CABLE:4.15 X 0.375,ALUMINUM (ATTACHING PARTS)	80009	343-1276-00	
-31	211-0304-00			2	SCR,ASSEM MSHR:4-40X0.312,PNH,STL,T9 TORX (END ATTACHING PARTS)	01536	ORDER BY DESCR	
-32	220-0022-00			4	NUT BLOCK:0.4 X 0.25 X 0.33,4-40 THRU (ATTACHING PARTS)	80009	220-0022-00	
-33	211-0304-00			4	SCR,ASSEM MSHR:4-40X0.312,PNH,STL,T9 TORX (END ATTACHING PARTS)	01536	ORDER BY DESCR	
-34	386-5296-00			1	PANEL,REAR: (ATTACHING PARTS)	80009	386-5296-00	
-35	213-0904-00			4	SCREW,TPG,TR:6-32 X 0.5,PNH,STL (END ATTACHING PARTS)	83385	ORDER BY DESCR	

STANDARD ACCESSORIES

062-8894-00	1	DATA SHEET:067-1261-00 FLEX EXTENDER	80009	062-8894-00
-------------	---	--------------------------------------	-------	-------------

CROSS INDEX - MFR. CODE NUMBER TO MANUFACTURER

<u>Mfr. Code</u>	<u>Manufacturer</u>	<u>Address</u>	<u>City, State, Zip Code</u>
01536	TEXTRON INC CAMCAR DIV SEMS PRODUCTS UNIT	1818 CHRISTINA ST	ROCKFORD IL 61108
22599	AMERACE CORP ESNA DIV	15201 BURBANK BLVD SUITE C	VAN NUYS CA 91411
78189	ILLINOIS TOOL WORKS INC SHAKEPROOF DIVISION	ST CHARLES ROAD	ELGIN IL 60120
80009	TEKTRONIX INC	4900 S W GRIFFITH DR P O BOX 500	BEAVERTON OR 97077
83385	MICRODOT MANUFACTURING INC GREER-CENTRAL DIV	3221 W BIG BEAVER RD	TROY MI 48098
85471	BOYD INDUSTRIAL RUBBER DIV OF A B BOYD CO	2527 GRANT AVE	SAN LEANDRO CA 94579

