

067-0528-00 CALIBRATION FIXTURE

Test Load Unit



The Type 067-0528-00 provides LO-LOAD equivalent to one Type 122 Amplifier Unit and HI-LOAD equivalent to four Type 122 Amplifier Units, to check 125 Power Supply.

This load unit in conjunction with a $\pm 0.25\%$ or better, nonloading voltmeter and a Tektronix 530/540 Series Oscilloscope with a "D" Plug-In will meet the necessary requirements.*

This unit is not designed to be used on the HI-LOAD position for extended periods, because of insufficient heat dissipation (10 minutes maximum operating time with 30% duty cycle).

*If a nonloading voltmeter of this accuracy ($\pm 0.25\%$) is not available, the LOAD UNIT may be returned to Tektronix, Inc., for certification.

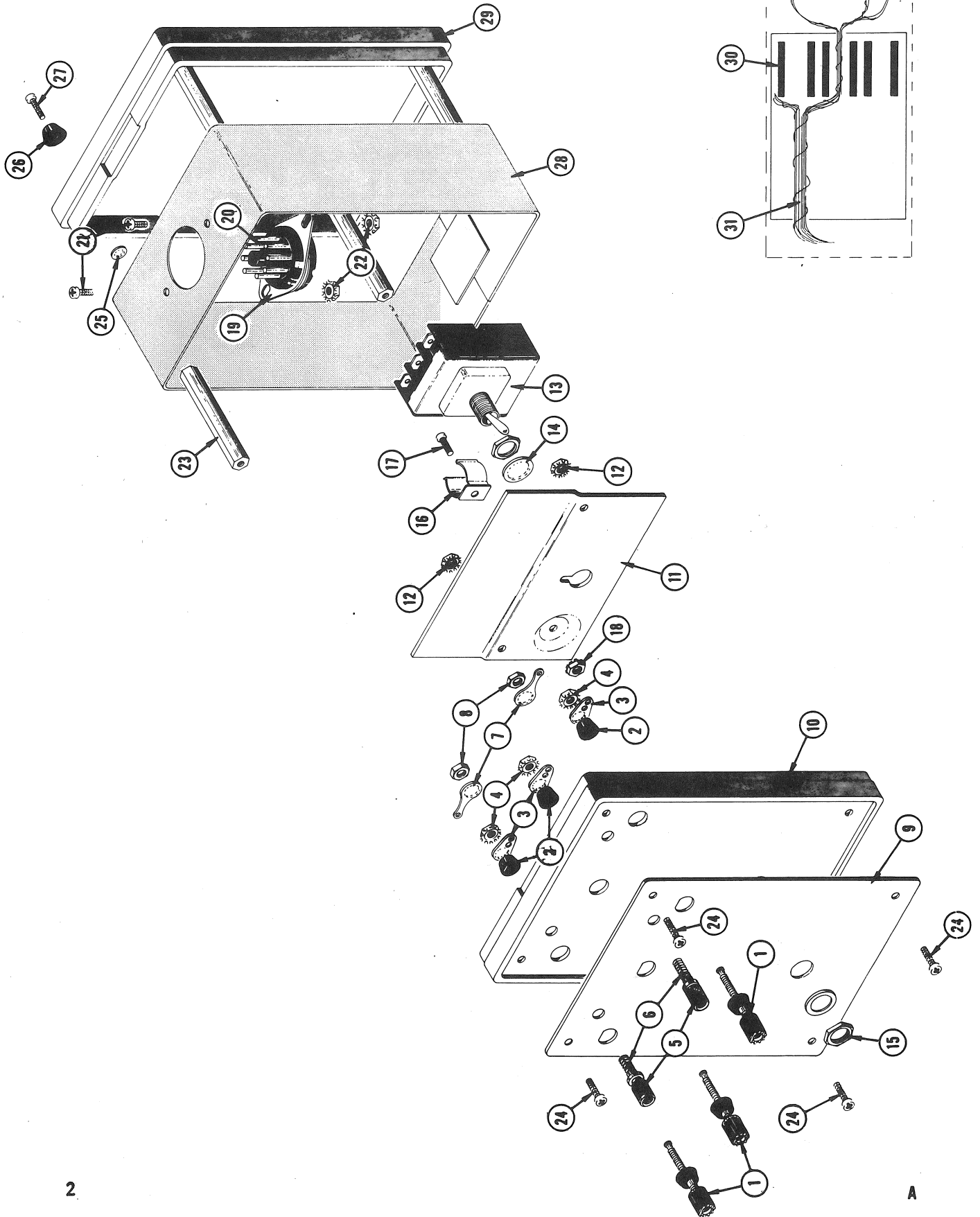

MECHANICAL PARTS LIST-067-0528-00

FIG. & INDEX NO.	TEKTRONIX PART NO.	SERIAL/MODEL EFF DISC	Q T Y	DESCRIPTION
1	129-0064-00 - - - - - - - - - -		3	POST, binding - mounting hardware for each: - (not included w/post)
2	358-0181-00		1	BUSHING, plastic
3	210-0202-00		1	LUG, solder, SE #6
4	210-0457-00		1	NUT, keps, 6-32 x 5/16 inch
5	200-0103-00		2	CAP, binding post
6	355-0507-00 - - - - - - - - - -		2	STEM, binding post adapter - mounting hardware for each: - (not included w/stem)
7	210-0223-00		1	LUG, solder, 1/4 ID x 7/16 inch OD, SE
8	210-0455-00		1	NUT, hex., 1/4-28 x 3/8 inch
9	E 333-0958-01		1	PANEL, front
10	E 200-0277-04		1	COVER, sub-panel, front
11	E 441-0694-00 - - - - -		1	CHASSIS - mounting hardware: (not included w/chassis)
12	210-0457-00		2	NUT, keps, 6-32 x 5/16 inch
13	260-0143-00 - - - - - 210-0414-00		1	SWITCH, toggle--HI-LOAD LO-LOAD - mounting hardware: (not included w/switch)
14	210-0021-00		1	NUT, hex., 15/32-32 x 9/16 inch
	210-0902-00		1	LOCKWASHER, internal, 0.472 ID x 0.480 inch OD
15	210-0473-00		1	WASHER, flat, 0.470 ID x 21/32 inch OD NUT, 12 sided, 15/32-32 x 0.634 inch
16	344-0116-00 - - - - -		1	CLAMP - mounting hardware: (not included w/clamp)
17	211-0008-00		1	SCREW, 4-40 x 1/4 inch, PHS
18	210-0586-00		1	NUT, keps, 4-40 x 1/4 inch

FIG. & INDEX NO.	TEKTRONIX PART NO.	SERIAL/MODEL EFF DISC	Q T Y	DESCRIPTION
19	386-0251-00		1	PLATE, 8 pin plug
	354-0002-00		1	RING, plug retaining
20	134-0006-00		1	PLUG, 8 pin, male
	- - - - -		-	mounting hardware: (not included w/plug)
21	211-0504-00		2	SCREW, 6-32 x 1/4 inch, PHS
22	210-0457-00		2	NUT, keps, 6-32 x 5/16 inch
23	E129-0108-00		4	POST, metal
	- - - - -		-	mounting hardware for each:
	- - - - -		-	(not included w/post)
24	211-0071-00		1	SCREW, 4-40 x 3/8 inch, THS
25	210-0004-00		1	LOCKWASHER, internal, #4
26	348-0037-00		1	FOOT, rubber
27	211-0013-00		1	SCREW, 4-40 x 3/8 inch, RHS
38	E380-0112-00		1	CABINET, wrap-around
29	E200-0277-05		1	COVER, rear
30	124-0158-00		6	STRIP, ceramic, 7/16 inch h, w/7 notches
	- - - - -		-	each strip includes:
	355-0082-00		2	STUD, plastic
	- - - - -		-	mounting hardware for each:
	- - - - -		-	(not included w/strip)
	361-0007-00		2	SPACER, plastic, 0.188 inch long
31	E179-1201-00		1	CABLE HARNESS

ELECTRICAL PARTS LIST-067-0528-00

Values are fixed unless marked Variable.

Ckt. No.	Tektronix Part No.	Serial/Model No. Eff	Disc	Description		
Resistors						
Resistors are fixed, composition, $\pm 10\%$ unless otherwise indicated.						
R1	303-0273-00		27 k Ω	1 W		5%
R3	303-0273-00		27 k Ω	1 W		5%
R4	303-0273-00		27 k Ω	1 W		5%
R5	303-0273-00		27 k Ω	1 W		5%
R7	308-0344-00		18.2 Ω	3 W	WW	1%
R8	308-0344-00		18.2 Ω	3 W	WW	1%
R9	308-0344-00		18.2 Ω	3 W	WW	1%
R11	308-0205-00		2 Ω	25 W	WW	5%
R14	303-0183-00		18 k Ω	1 W		5%
R16	303-0183-00		18 k Ω	1 W		5%
R17	303-0183-00		18 k Ω	1 W		5%
R18	303-0183-00		18 k Ω	1 W		5%

Switch

	Unwired					
SW12	260-0143-00		Toggle		HI-LOAD	
					LO-LOAD	

SCHEMATIC

